

## **CW-LJX-0117**

### **Antenna Extension Cable**

#### **Key Features**

Frequency: 0-6G

IPEX To IPEX

Cable length 60mm



## 1. Antenna Cable Electrical Characteristics

Band (MHz)	
Frequency (MHz)	0-6G
VSWR	1.6
Impedance (Ohm)	50
Max. Input Power (W)	10

## 2. Material and environmental characteristics

Connector 1	IPEX
Connector 2	IPEX
Cable Type	RF 1.13
Dimensions (mm)	60MM
Operation Temperature	-40 to +80
Storage Temperature	-40 to +80
Antenna Storage life(year)	10
Substance Compliance	ROHS

A	B	C	D	E	F	G
Cable item	Cable material	O.D. (mm)	Specifications			
Conductor	Tinned Copper Wire	0.24±0.05	7/0.08			
Insulation	FEP	0.7±0.05	0.23			
Shield	Tinned Copper Wire	0.92±0.05	16*4/0.05			
Jacket	FEP	1.13±0.05	0.1			

REV	Date	Description
X1	2023/05/31	New Issue

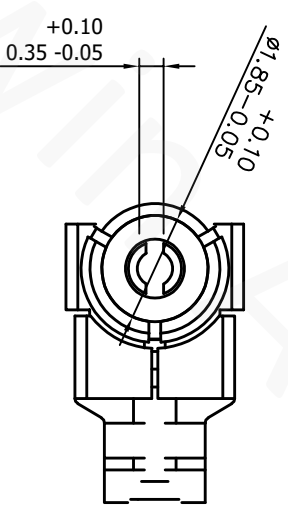
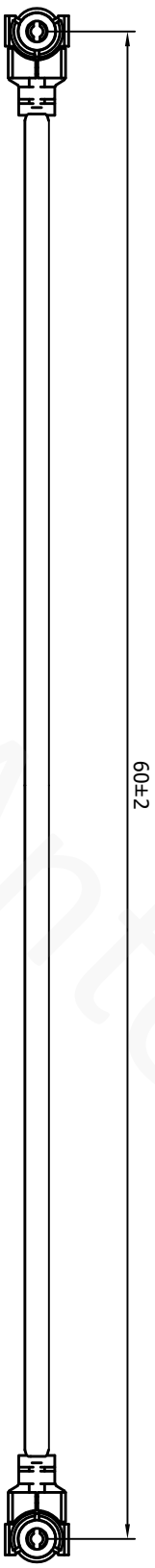
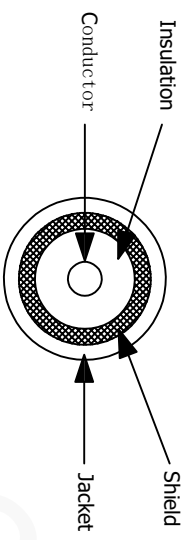

Frequency Range: 0-6G  
 Impedance: 50Ω  
 V.S.WR ≤ 1.6 (0-6G)  
 100% Continuity, short and open circuit test  
 Materials, parts and process must by environmentally (ROHS)

NO	Name	Description	QTY	Remark
2	Cable	φ1.13 Black double tin wire	1	YUANDA
1	Connector	φ1.13 I-PEX I	2	I-PEX

XX	±5.0	Approved	Customer
X	±3.0	Checked	Part NO. 21-5-00-1003
X	±1.0		Part name IPEX Cable
.XX	±0.2	Drawing	CW P/NO. CW-LIX-0117
XXX	±0.1		REV X1 Unit m/m File : Sheet: 1/1



**Cowin Antenna**

## 4.1 VSWR

